

No thinset means  
less weight!

PROFESSIONAL-GRADE

**Black Gold**<sup>®</sup>  
By Gold Heat

## Electric Radiant Floor Heat Film

For a lightweight, low-profile installation that  
does not require thinset or wire-running.

MADE FOR USE UNDER



LVP



LVT



Sheet vinyl



Laminate

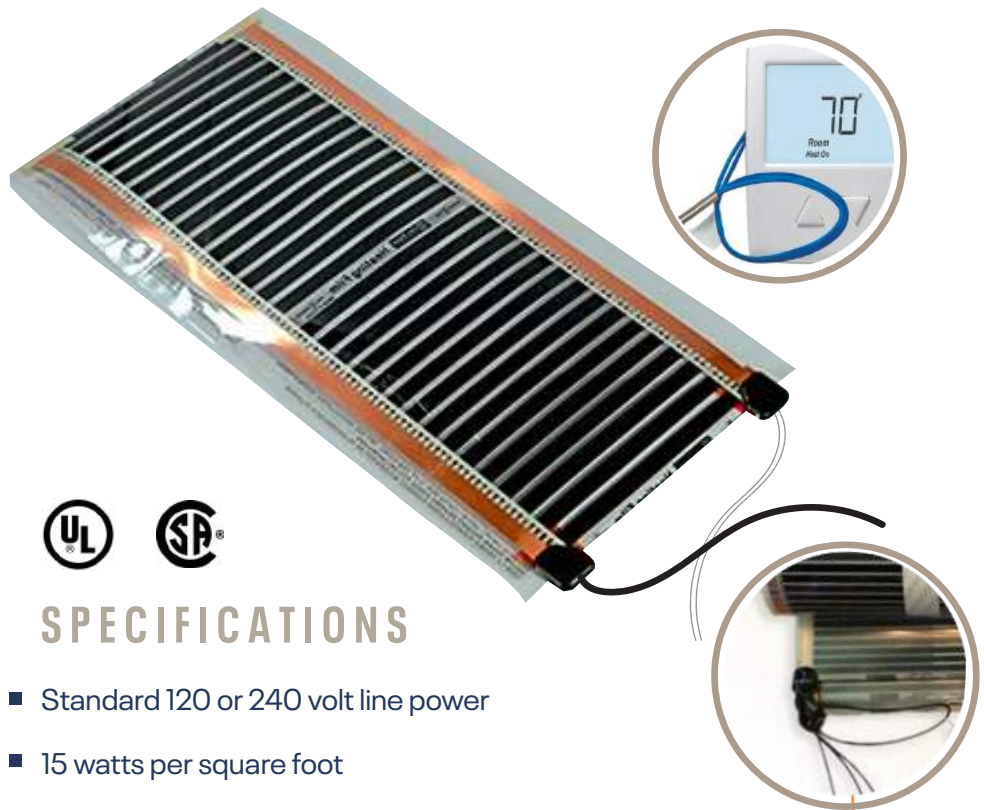

### SPECIFICATIONS

- Standard 120 or 240 volt line power
- 15 watts per square foot
- Available in 10" and 20" widths configured up to 35' long
- Pre-terminated cold lead - select 10', 15', 20' lengths available
- Black Gold's proprietary-design terminations are sealed in rigid thermoplastic. No special connector needed!
- Multiple film panels can be connected in parallel to the same thermostat 1800 watts @ 120 volts; 3600 watts @ 240 volts
- Black Gold heat film weighs approx. 1.6 oz / heated sf

Ask about our line of  
floor heat thermostats

PROUD MEMBER



goldheat.com

# INSTALLATION

## LUXURY MOTOR COACH FLOOR PLAN

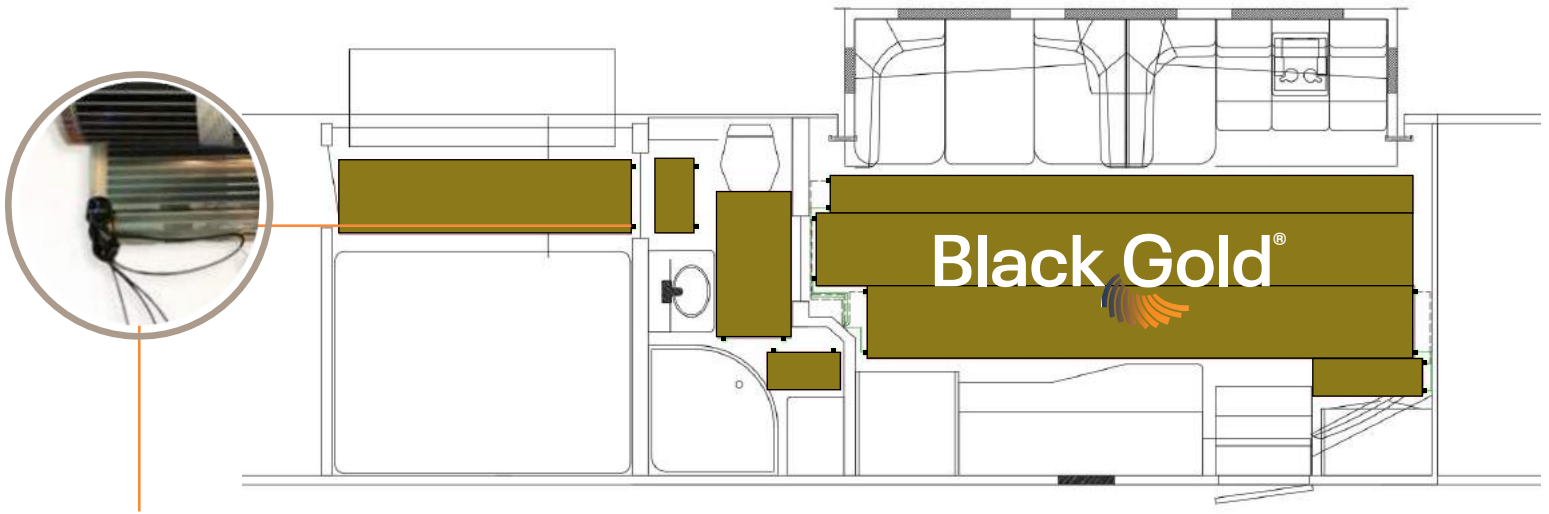

Black Gold's proprietary-design terminations are sealed in rigid thermoplastic. No special connector needed!

Black Gold™ is a thin, pre-terminated and pre-cut radiant floor heat film that lays on top of the subfloor, under the flooring material adding just 1/16" to the total floor stack-up\*.

\* Total stack-up varies with flooring material

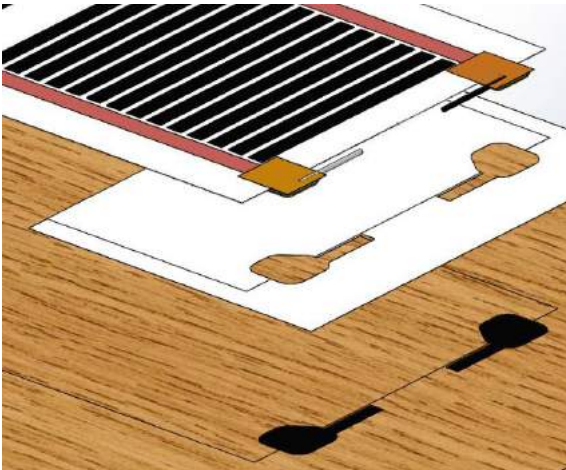

During a typical installation, pockets and grooves are routed into the subfloor to accept the cold lead wires.

The Black Gold film is adhered to the subfloor and the flooring material is installed on top.

Gold Heat design engineers are standing by to help you before, during, and after the installation.

/therealgoldheat



We want to be a help with your coach installation.

Talk to us, today!

design@goldheat.com | 877.789.4328



Gold Heat.com

The building & remodeling industry's radiant floor heat source.

### Headquarters

5295 NE Elam Young Pkwy  
Suite 130  
Hillsboro, OR 97124  
(866) 935.7782

### Showroom | Studio

5285 NE Elam Young Pkwy  
Suite A100  
Hillsboro, OR 97124  
(503) 848.6190